

STRAIGHT PCB RECEPTACLE
EDGE CARD - PIN IN PASTE VERSION

R197.160.Z07

Series : **SMB**
CARLOCK

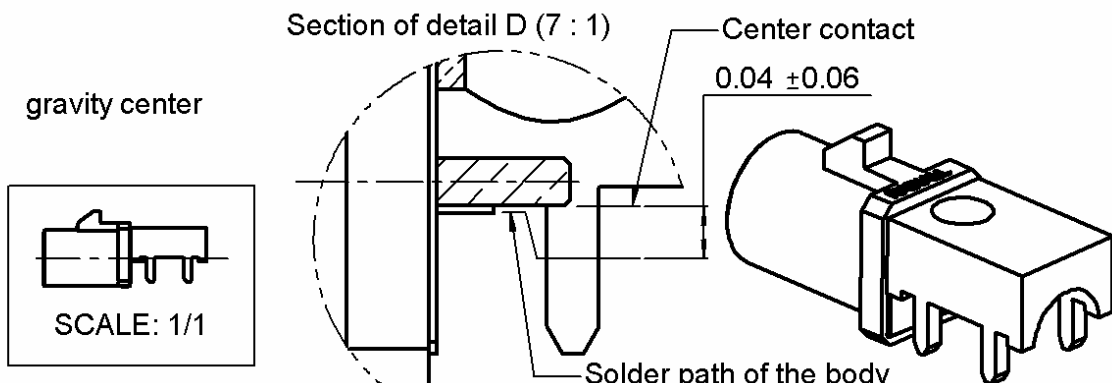
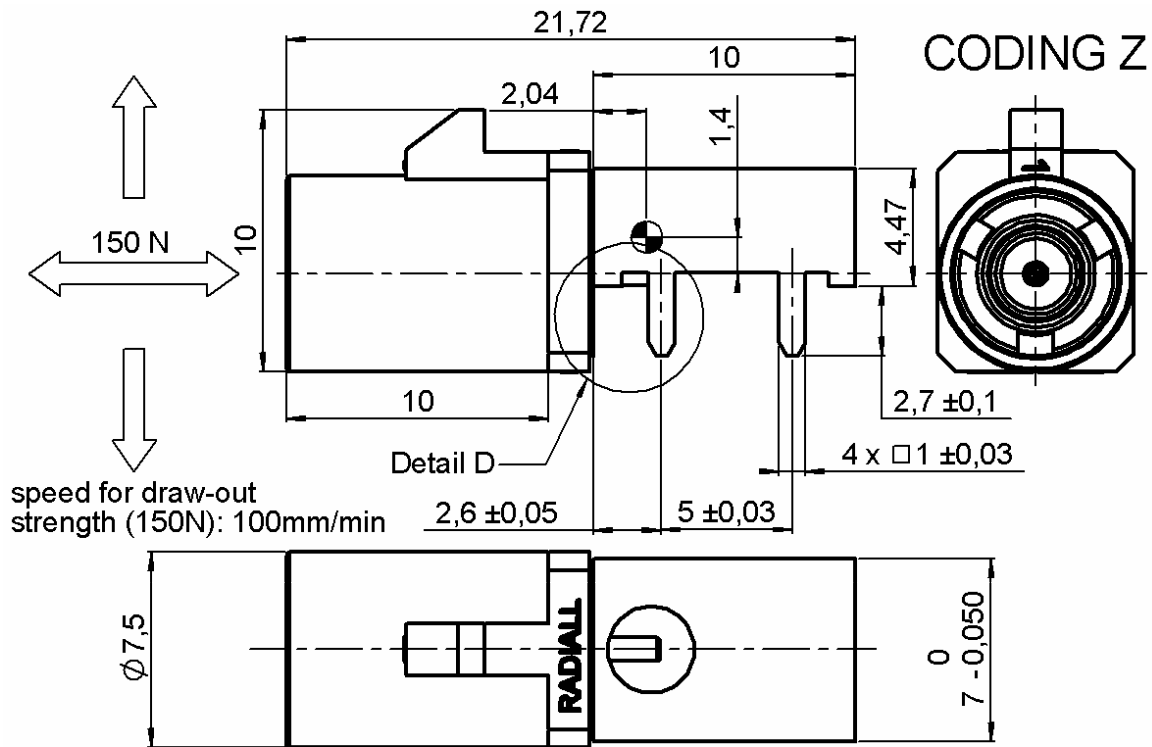

All dimensions are in mm.

COMPONENTS	MATERIALS	PLATING (µm)
BODY	BRASS	GOLD 0.2 OVER NICKEL 2
CENTER CONTACT	BRASS	GOLD 0.5 OVER NICKEL 2
OUTER CONTACT	-	-
INSULATOR	PTFE	-
GASKET	-	-
OTHERS PARTS	-	-
.	-	-
.	-	-
.	-	-
HOUSING PA 4.6 30%GF		UL CLASSIFICATION UL 94 V2
		COLOR Water Blue RAL 5021

* According to FAKRA specification

Issue : 0636 A
 In the effort to improve our products, we reserve the right to make changes judged to be necessary.



STRAIGHT PCB RECEPTACLE
EDGE CARD - PIN IN PASTE VERSION

R197.160.Z07

Series : **SMB**
CARLOCK

PACKAGING

SPECIFICATION

Standard	Unit	Other
350	'W' option	Contact us

QS9000

ELECTRICAL CHARACTERISTICS

ENVIRONMENTAL

Impedance	50	Ω
Frequency	0-4	GHz
VSWR	1.06* + 0,0130	x F(GHz) Maxi
Insertion loss	0.03*	$\sqrt{F(GHz)}$ dB Maxi
RF leakage	- (- F(GHz)) dB Maxi
Voltage rating	335	Veff Maxi
Dielectric withstanding voltage	1000	Veff mini
Insulation resistance	1000	M Ω mini

Operating temperature	-40/+110	$^{\circ}$ C
Hermetic seal	NA	Atm.cm3/s
Panel leakage	NA	

OTHER CHARACTERISTICS

Assembly instruction

Others :

*COAX TRANSMISSION LINE ONLY

MECHANICAL CHARACTERISTICS

Center contact retention		
Axial force – Mating end	10	N mini
Axial force – Opposite end	10	N mini
Torque	NA	N.cm mini
Recommended torque		
Mating	NA	N.cm
Panel nut	NA	N.cm
Mating life	100	Cycles mini
Weight	2,7900	g

Issue : 0636 A

In the effort to improve our products, we reserve the right to make changes judged to be necessary.



STRAIGHT PCB RECEPTACLE
EDGE CARD - PIN IN PASTE VERSION

R197.160.Z07

Series : SMB
 CARLOCK

MOUNTING ZONE FOR RECEPTACLE

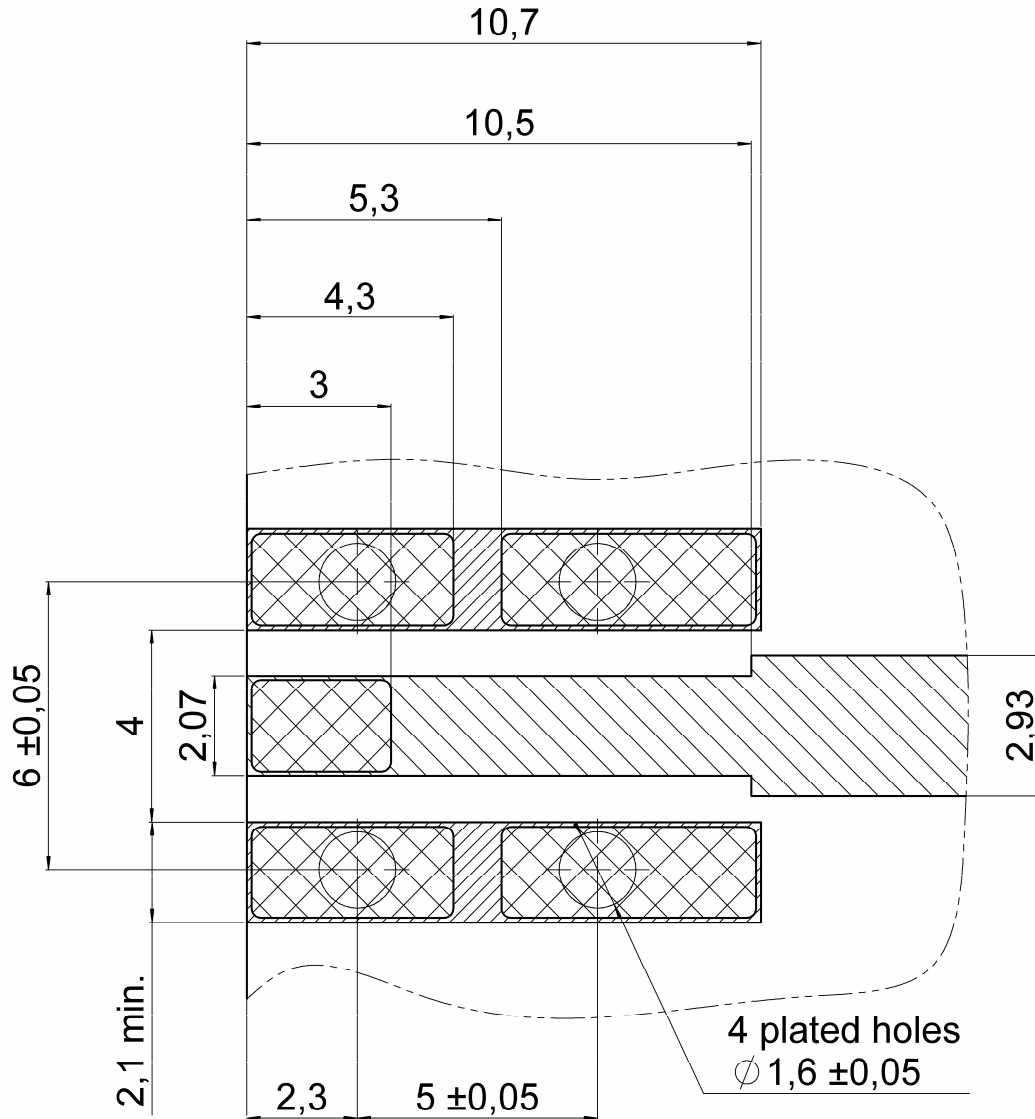

Thickness of PCB: 1,6 mm.

Material of PCB: FR4 ($\epsilon_r = 4.6$).

Solder paste has to be printed onto the land of solder and into holes to permit Pin In Hole Reflow

-  Ground track
-  Signal track
-  Land for solder

Issue : 0636 A

In the effort to improve our products, we reserve the right to make changes judged to be necessary.



STRAIGHT PCB RECEPTACLE
EDGE CARD - PIN IN PASTE VERSION

R197.160.Z07

Series : **SMB**
CARLOCK

SOLDER PROCEDURE

- 1 - Deposit solder paste "Sn Ag4 Cu0.5" on mounting zone by screen printing application. We recommend a low Residue Solid Flux.
 We advise a thickness of 0,2 millimetres min. (0,008 inch min.).
 The holes must be totally filled with cream
 Verify that the edges of the zone are clean.
- 2 - Placement of the receptacle on the mounting zone with an automatic machine of "pick and place" type.
 Video camera is preferred to check the positioning of the component .
 Adhesive agents are forbidden on the receptacle.
- 3 - Soldering by reflow process.
 The typical profile to use is given below.
- 4 - Clean printed circuit boards.
- 5 - Check of solder joints and position of the component by visual inspection

TEMPERATURE PROFILE

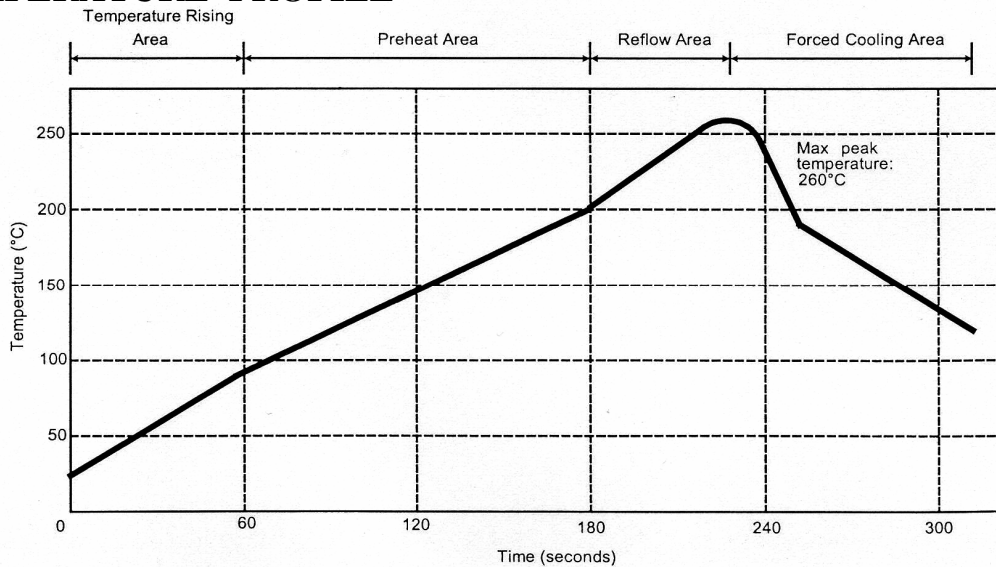

Parameter	Value	Unit
Temperature rising Area	1 - 4	°C/sec
Max Peak Temperature	260	°C
Max dwell time @260°C	10	sec
Min dwell time @235°C	20	sec
Max dwell time @235°C	60	sec
Temperature drop in cooling Area	-1 to - 4	°C/sec
Max dwell time above 100°C	420	sec

Issue : 0636 A

In the effort to improve our products, we reserve the right to make changes judged to be necessary.



STRAIGHT PCB RECEPTACLE
EDGE CARD - PIN IN PASTE VERSION

R197.160.Z07

Series : **SMB**
CARLOCK

REEL PAKAGING PER 350

CELL MATERIAL :
 Polycarbonate
 COVER TAPE MATERIAL :
 conductive polyester film tape

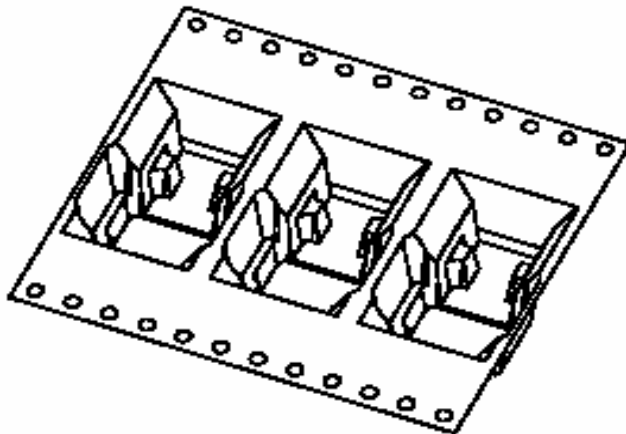
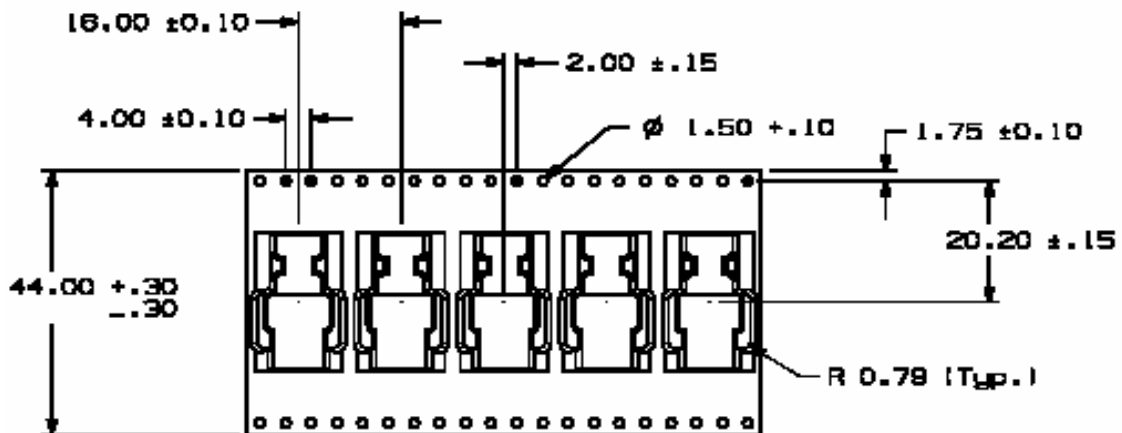
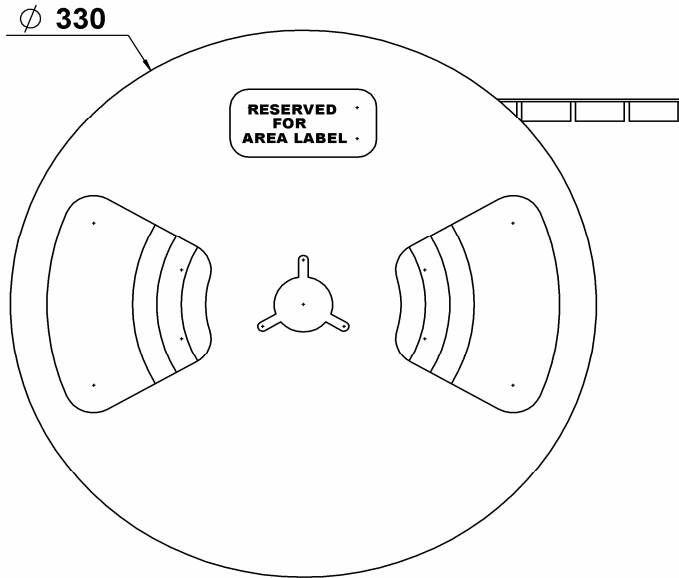

Issue : 0636 A

In the effort to improve our products, we reserve the right to make changes judged to be necessary.









STRAIGHT PCB RECEPTACLE

R197.160.Z07

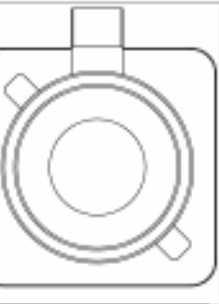
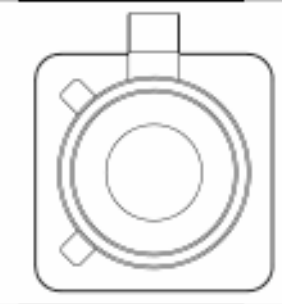
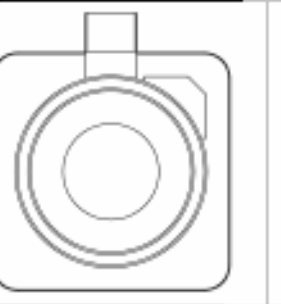
EDGE CARD - PIN IN PASTE VERSION

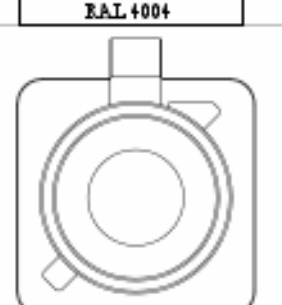
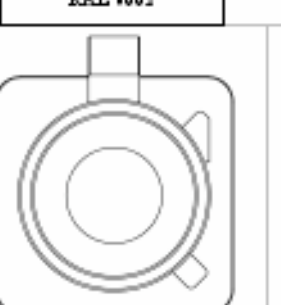
Series : SMB
CARLOCK

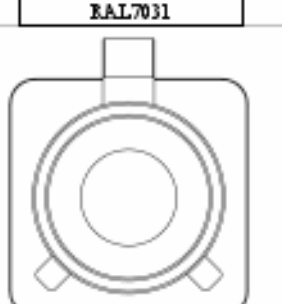
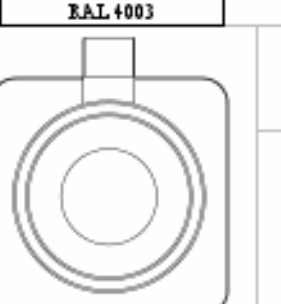
		
CODING A COLOR BLACK RAL 9005	CODING B COLOR CREAM WHITE RAL 9001	CODING C COLOR BLUE RAL 5005
		
CODING D COLOR BORDEAUX VIOLET RAL 4004	CODING E COLOR GREEN RAL 4002	CODING F COLOR BROWN RAL 8011
		
CODING G COLOR GREY RAL 7031	CODING H COLOR VIOLET RAL 4003	CODING I COLOR BEIGE RAL 1001
		UL CLASSIFICATION UL 94V-2
CODING K COLOR CURRY RAL 1027	CODING Z COLOR WATER BLUE RAL 5021	

*According to FAKRA specifications

To obtain other coding for the connector please change the letter by the needed coding letter into the Part Number

Issue : 0636 A

In the effort to improve our products, we reserve the right to make changes judged to be necessary.



STRAIGHT PCB RECEPTACLE
EDGE CARD - PIN IN PASTE VERSION

R197.160.Z07

Series : **SMB**
CARLOCK

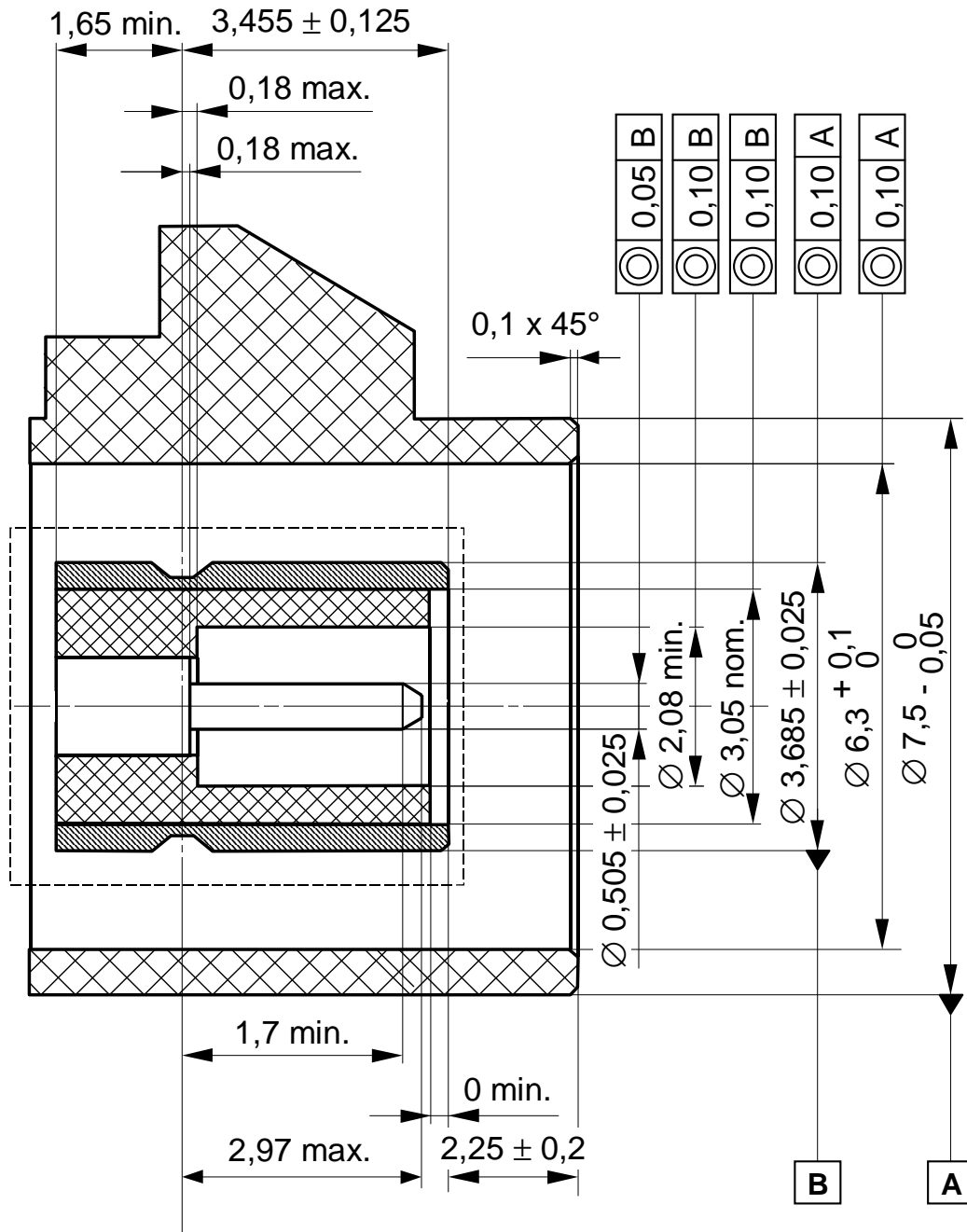

Issue : 0636 A

In the effort to improve our products, we reserve the right to make changes judged to be necessary.



RADIALL®